

safe - compact - drive
 with redundant control unit
 type: SKA-ARX-Pic-HE-AoP

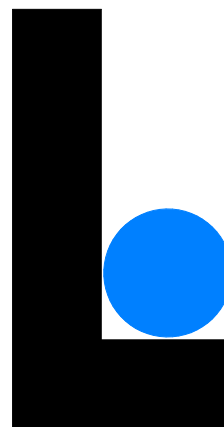

LIBERDA
 Antriebstechnik

motor
 scale 15

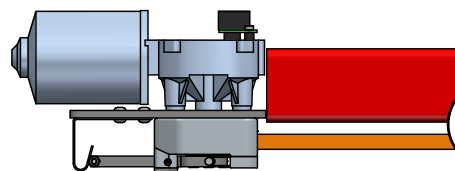
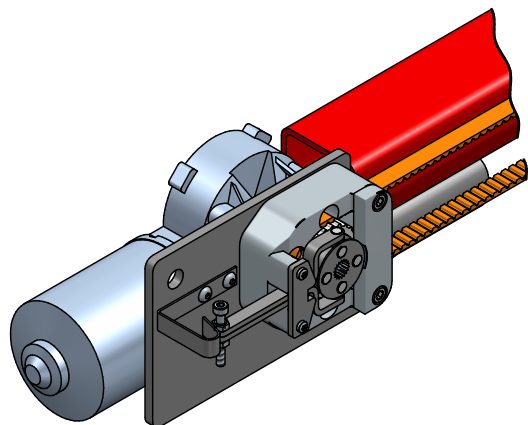
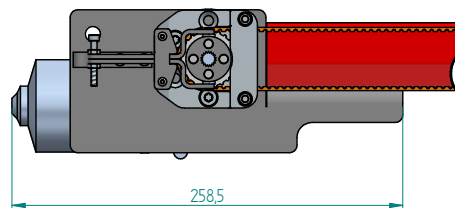
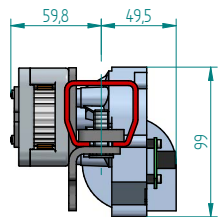

toothbelt carrier & diverter pulley
 scale 15

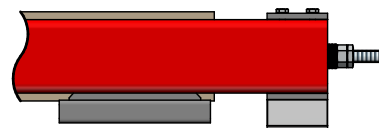
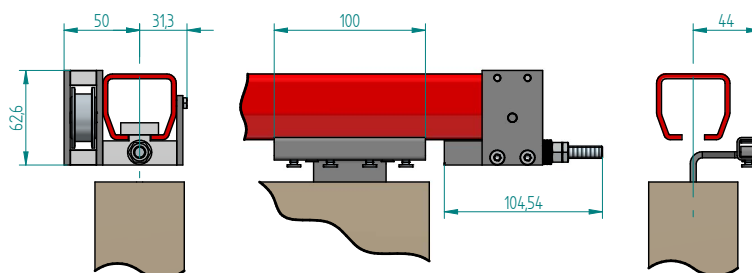
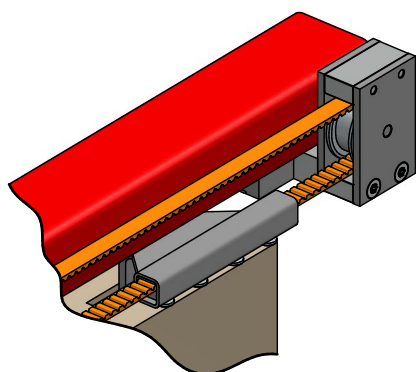

technical data:

type
 name of gearbox
 pinion
 drive means

SKA-ARX-HE-AoP
 PICCOLO
 AT5-25
 toothbelt AT5,
 maximum tensile load: 700N,
 4 - fold break resistance

motor designation
 voltage
 output speed
 torque

DCK 31-405 006
 24V
 4300/min
 0,1Nm

gearbox producer
 reduction
 maximum torque
 nominal pulling force
 speed

VALEO
 i = 1:69
 4Nm
 150N
 15cm/s

The drive is suitable for:
 dead -/ automatic operation:

100.000 cyclus,
 for door leaf mass max. 250kg

the drive has:

sensitivity control
 emergency electrical battery

The door can not be moved by hand. Emergency release is possible.

control unit
 scale 1:10

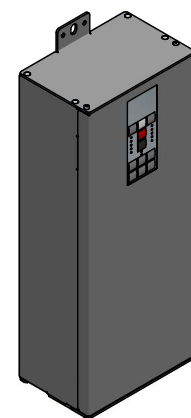
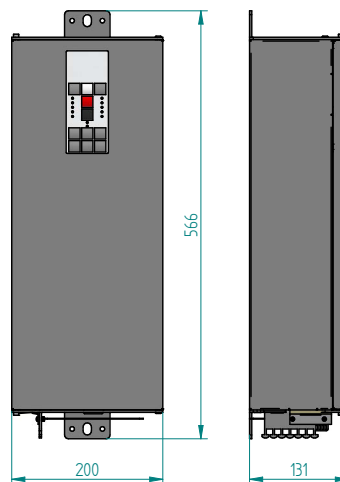

Liberda Antriebstechnik GmbH
 A-1150 Wien
 Geibelgasse 14-16
 ☎+43 1 8953244
 📠+43 1 8953244 20
 ✉antriebe@liberda.eu
 www.liberda.eu
 HG Wien FN113227k