

safe - compact - drive
with redundant control unit
type: SKA-ARX-HE-S-2

motor

scale 1:5

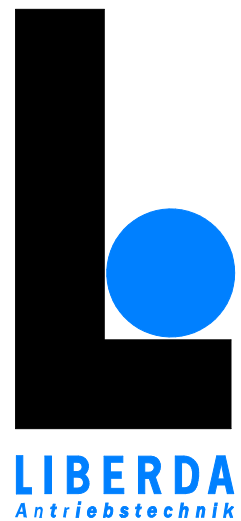
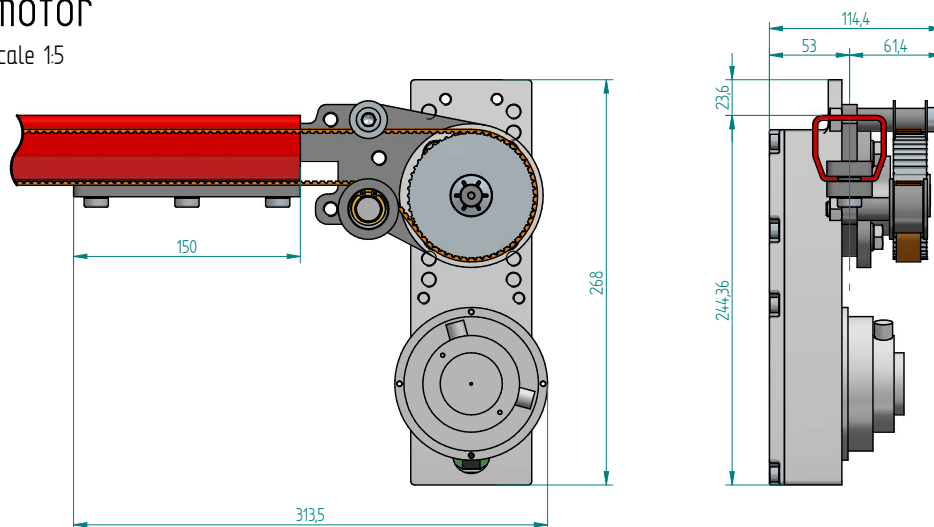

toothbelt carrier & diverter pulley

scale 1:5

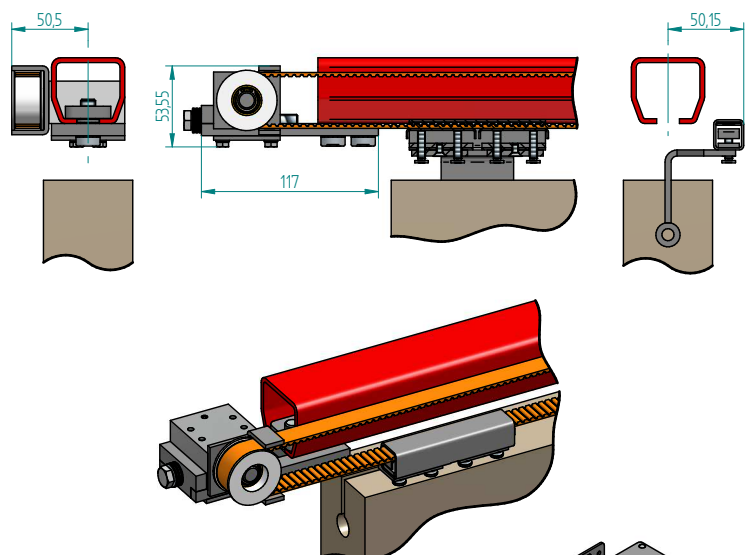
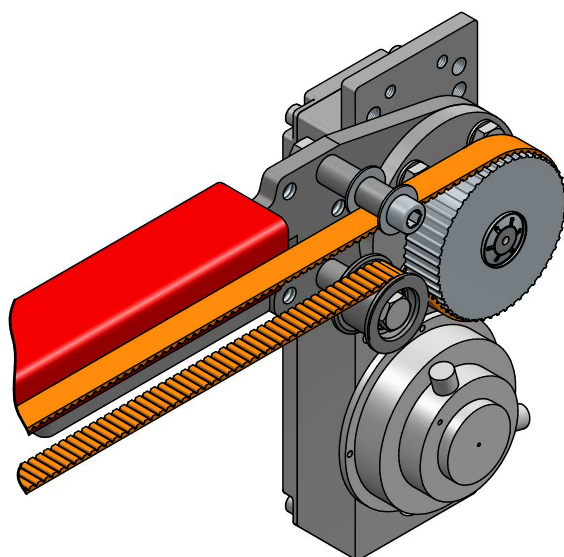

technical data:

type
name of gearbox
pinion
drive means

SKA-ARX-HE-S-2
hanging - fast
AT5-54
toothbelt 16AT5,
maximum tensile load 1120N,
4 - fold break resistance

motor designation
voltage
output speed
torque

Baumüller GDM80N
24V
2700/min
0,25Nm

gear box producer
reduction
maximum torque
nominal pulling force
speed

Liberda Antriebstechnik
 $i = 136,1$
9,25Nm
198N
40cm/s

The drive is suitable for
dead- or automatic operation:

200.000 cycles,
for door leaf mass max. 250kg
sensitivity control
emergency electrical battery

The drive has:

The door can be moved by hand.

control unit

M1:10

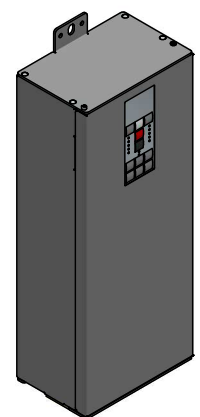
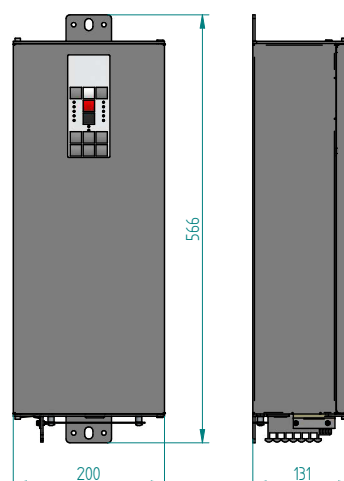

Liberda Antriebstechnik GmbH
A-1150 Wien
Geibelgasse 14-16
☎ +43 1 8953244
☎ +43 1 8953244 20
✉ antriebe@liberda.eu
www.liberda.eu
HG Wien FN113227k