

safe - compact - drive
with redundant control unit
type: SKA-ARX-HE-S-5

motor

scale 1:5

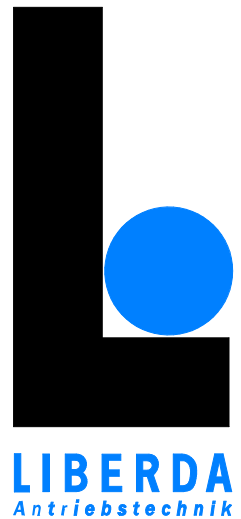
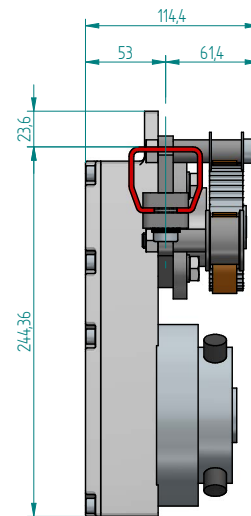
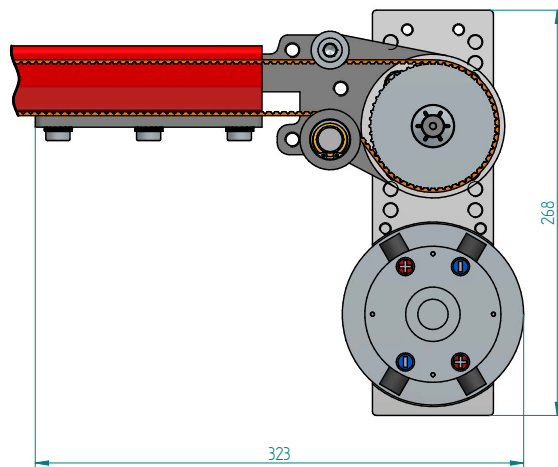

toothbelt carrier & diverter pulley

scale 1:5

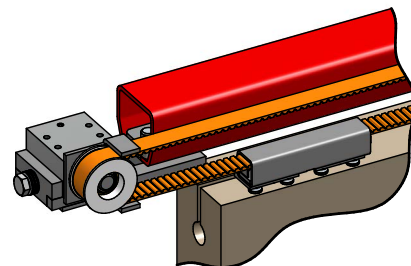
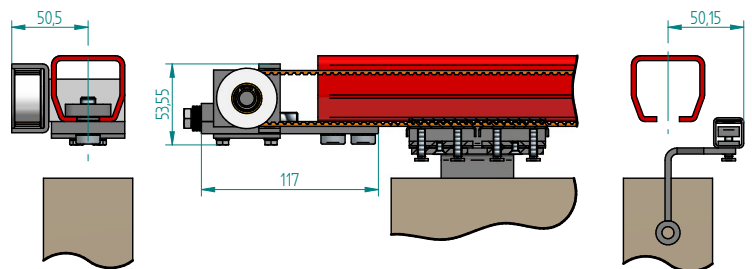
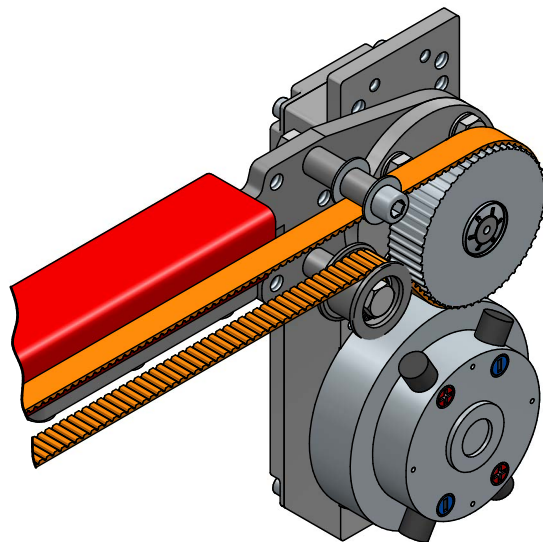

technical data:

type
name of gearbox
pinion
drive means

SKA-ARX-HE-S-5
hanging - fast
AT5-54
toothbelt 16AT5,
maximum tensile load 1120N
4 - fold break resistance

motor designation
voltage
output speed
torque

Baumüller GDM100N2
24V
2300/min
0,85Nm

gear box producer
reduction
maximum torque
nominal pulling force
speed

Liberda Antriebstechnik
 $i = 1:36,1$
29Nm
676N
40cm/s

The drive is suitable for
deadman- or automatic operation:

200.000 cyclus,
for door leaf mass max. 500kg
sensitivity control
emergency electrical battery

The drive has:

The door can be moved by hand.

control unit

scale 1:10

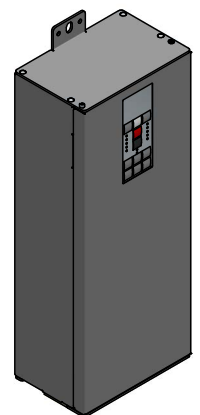
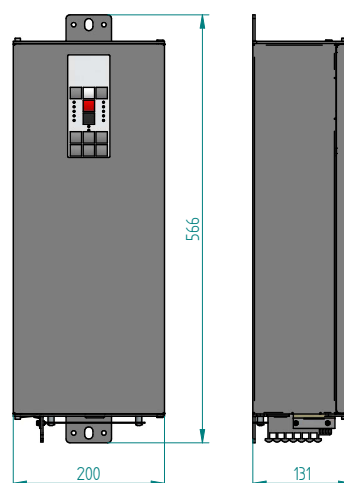

Liberda Antriebstechnik GmbH
A-1150 Wien
Geibelgasse 14-16
☎ +43 1 8953244
☎ +43 1 8953244 20
✉ antriebe@liberda.eu
www.liberda.eu
HG Wien FN113227k