

safe - compact - drive
with redundant control unit
type: SKA-ARX-0-3

drive motor

scale 15

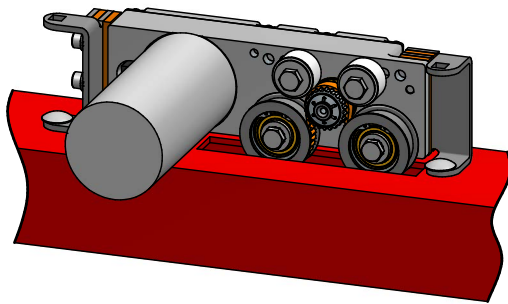
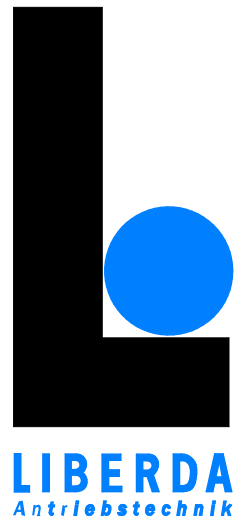
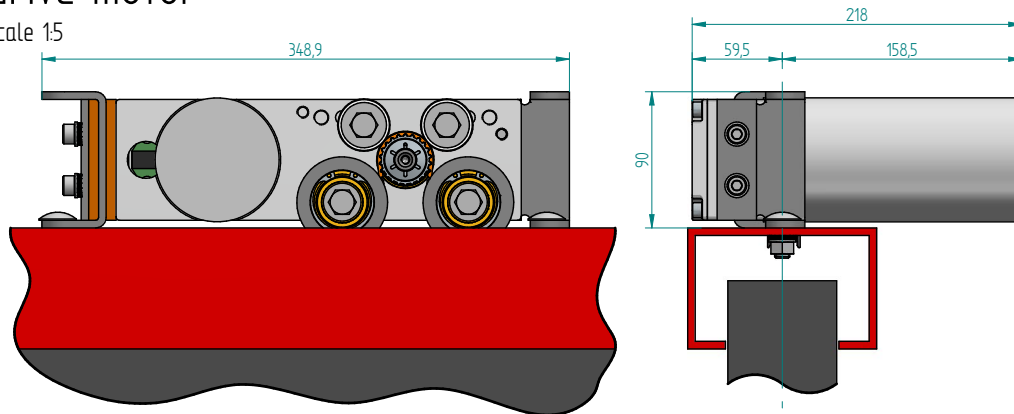

toothbelt - tensioner

M15

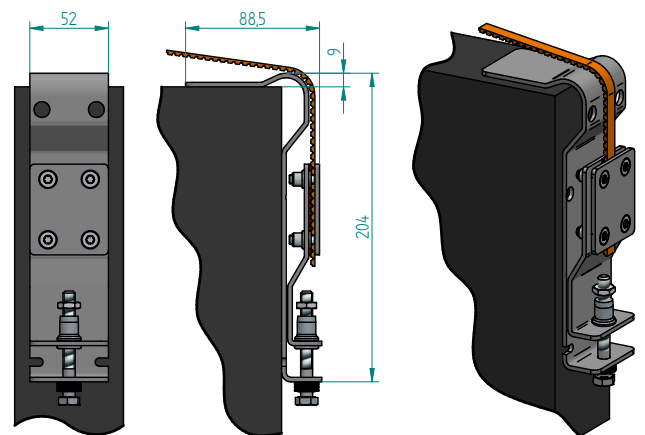

toothbelt clamp

scale 15

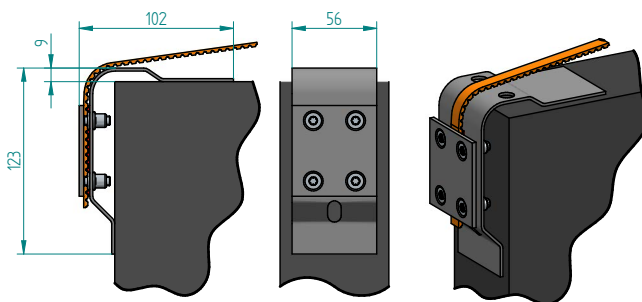

control unit

scale 1:10

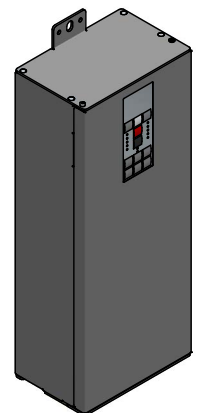
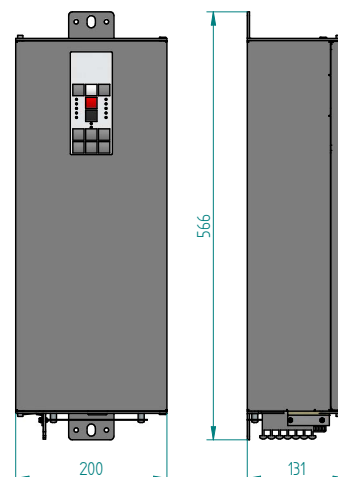

technical data:

type	SKA-ARX-0-3
name of gearbox	VLM
pinion	AT5/22
drive means	toothbelt AT5, maximum tensile load : 700N, 4 - fold break resistance
motor designation	M80L-56B14
voltage	24V
output speed	3000/min
torque	0,7Nm
gearbox producer	Liberda Antriebstechnik
reduction	i = 1:36,1
maximum torque	25Nm
nominal pull force	600N
speed	8cm/s
The drive has:	sensitivity control, emergency electrical battery

The door can be moved by hand.
For gate leaf weight max. 2500kg

Liberda Antriebstechnik GmbH
A-1150 Wien
Geibelgasse 14-16
☎ +43 1 8953244
☎ +43 1 8953244 20
✉ antriebe@liberda.eu
www.liberda.eu
HG Wien FN13227k